

This connector is for hot-plug use at 60 amps. It contains recessed contacts and a ribbed nose housing, thus providing finger proofing in environments where human contact is a consideration. Available in different colors, this genderless connector is mechanically keyed to ensure connectors will only mate with connectors of the same color.

With the silver-plated copper contacts, there is a maximum connect/disconnect life of 10,000 cycles, with a 150 volts continuous AC or DC operation. Accessories, such as integral cable clamp and handle, provide strain relief and ease of use.

## FEATURES

- **Meets UL 1950 finger probe test**

*Each half offers finger proofing and can be connected to two energized sources up to 150 volts AC/DC*

- **Auxiliary contacts**

*Provides additional poles up to 30 amps for auxiliary power, control or sensing*

- **Handle**

*Eases connector use and relieves unnecessary strain on cables when disconnecting*

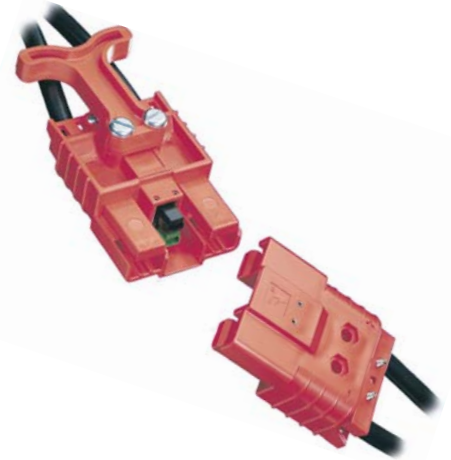

## PRODUCT SPECIFICATIONS

Connector Model	SBE®80	Connector Model	SBE®80
Current rating (main contacts)	80	Insulation with standing test voltage (volts AC/DC)	1300
Largest wire size (AWG)	#6 (60 amps)	Maximum wire insulation diameter (inches)	0.44
(mm <sup>2</sup> )	16 (80 amps)	(mm)	11.18
Maximum operating voltage AC/DC	150	Contact retention force (lbs)	50
Contact material	Silver plated copper	Life:	
Operating temperature range °C	-20° to 105°	a. No load (connect/disconnect cycles)	To 10,000
Flammability rating of housing material	UL94 V-0	b. Under load (hot plug 250 cycles @ 120V)	60A
AVG contact resistance* (microhoms)	200		

\*UL rated for 65°C rated wire or cable size

## ORDERING INFORMATION

### Housing Only

Part Number	Housing Color
SBE80RED	Red
SBE80YEL	Yellow
SBE80ORN	Orange
SBE80WHT	White

### Cable Clamp & Hardware

Part Number	Housing Color
SBE80CLPRED	Red
SBE80CLPYEL	Yellow
SBE80CLPORN	Orange
SBE80CLPWHT	White

### Housing, Contacts, Handle, Clamp & Hardware

Part Number	Housing Color
SBE80RED16MMHDL	Red
SBE80YEL16MMHDL	Yellow
SBE80ORN16MMHDL	Orange
SBE80WHT16MMHDL	White

### Contacts

Part Number	Description	Wire AWG	Wire sq. mm
1339G1	Contact set (2)	#6	16

### Handle/Hardware & Accessories

Part Number	Description
SBE80HDLRED	Red housing
SBE80HDLYEL	Yellow housing
SBE80HDLORN	Orange housing
SBE80HDLWHT	White housing
6344	Auxiliary contact kit

### Tooling

Part Number	Description
1309G4	Hand tool
1387G1	Pneumatic tool
1388G6	- die for #6 AWG/16 mm
1389G6	- locator for #6 AWG/16 mm

### Bushings

Part Number	Description	Wire AWG	Wire sq. mm
5912	Use with 1339G1	#6 to #8	3.3/8.4
5910	Use with 1339G1	#6 to #10/12	13.3 to 5.3/3.3

## DIMENSIONS

	-A-		-C-		-D-		-E-		-F-	
Series	mm	in.	mm	in.	mm	in.	mm	in.	mm	in.
SBE <sup>®</sup> 80	47.9	1.89	14.6	.58	50.5	1.99	59.1	2.33	112.3	4.42

	-G-		-H-		-I-	
Series	mm	in.	mm	in.	mm	in.
SBE <sup>®</sup> 80	25.4	1.0	5.1	.20	10.4	.41

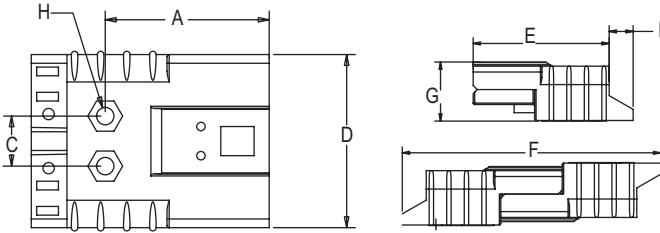

## TEMPERATURE RISE CHART

